

BREAKOUT

MEETINGS AT HARD ROCK HOTEL

HOLLYWOOD | FL





In 1971, two shaggy-haired Yanks opened an American diner in an old Rolls Royce dealership in London. It had nothing to do with market studies or target audiences. It didn't even have anything to do with memorabilia. That was just a goof: Clapton wants to save his favorite table - sure, we'll put the guitar on the wall. Four decades, 68 countries, 180+ Hard Rock Cafes and 35 hotels later, we're still saving tables for our rock star friends, and for millions upon millions of their fans.



LIVING OUR MOTTO'S

While music is the heart of Hard Rock, philanthropy is its soul, and Hard Rock International is committed to making a difference through a wide variety of philanthropic causes and activities. For more than 45 years, Hard Rock International has made it both its business and abiding passion to make the earth a safer, healthier and better place to live. Since opening in 1971, Hard Rock International has been committed to two consistent brand pillars: music and philanthropy. In 2016 Hard Rock International launched the Hard Rock Heals Foundation, a global charity that aims to improve lives through the power of music. Hard Rock's guiding principle, "Love All - Serve All," encompasses the brand's dedication to its core mantras - "Save The Planet," "Take Time To Be Kind" and "All is One."

LOVE ALL—SERVE ALL
TAKE TIME TO BE KIND
ALL IS ONE
SAVE THE PLANET

VIBE



Music is our essence. It can create moods and memories. It can make you move you to the floor or tuck you into bed. Music has a powerful effect on creativity. It can make you want to leave, or it can make you want to stay. Ignore it at your peril, as it is our potent brand differentiator and we take it very seriously. Our guests should not leave us and hear the same tracks at the mall or an airport food court that they have heard at our hotels. Hard Rock Hotel playlists are bespoke, lovingly hand crafted by our team of musical magicians. Remember that mix tape you made for your high school crush? Well our DJ's are crushing on our hotels. And their record collections are huge. But love is a two-way street, and that's one reason why our Vibe Managers, whom we refer to as the Visionary Individuals Behind the Experience, at each property are vital. Their input and expertise, their physical presence on the ground, is crucial in properly executing the music program.

MUSIC IS OUR ESSENCE.
IGNORE IT AT YOUR PERIL.

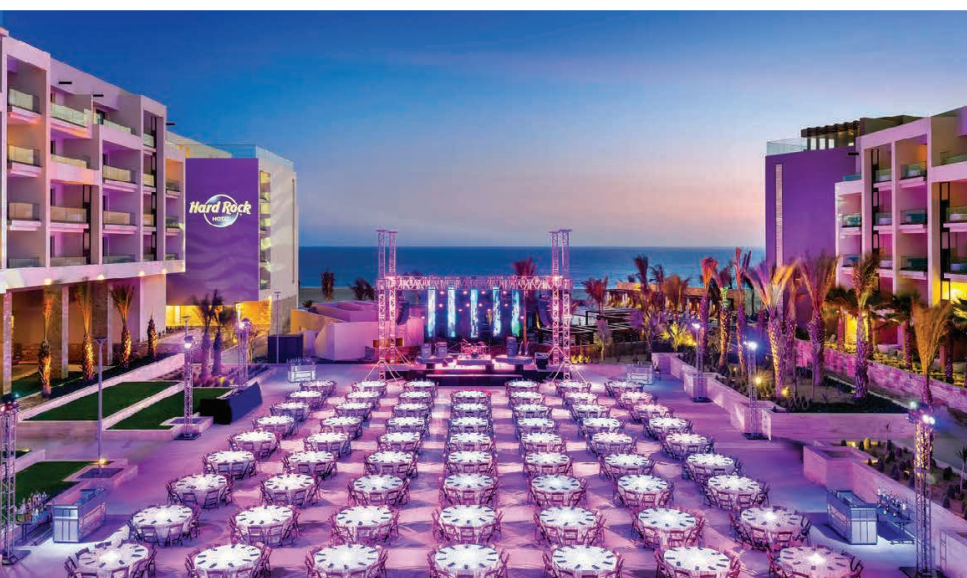
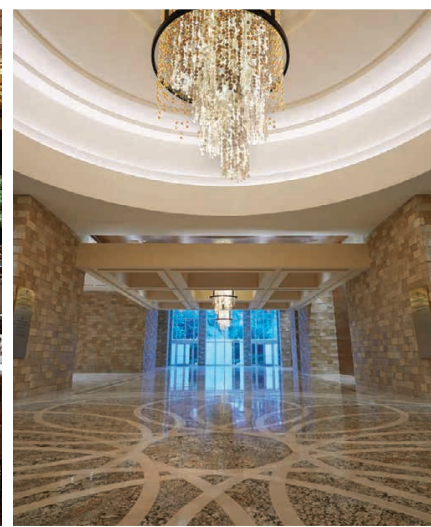
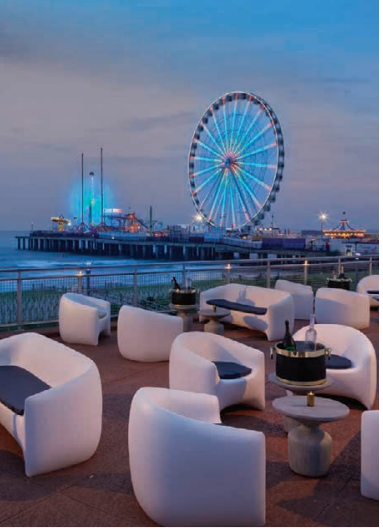

EVERYONE HAS SPACES, WE HAVE VENUES

From setup to sundown, our team of professionals is here to provide all you need to produce an unforgettable and unparalleled event. This is different with purpose, engaging with energy, and uniquely designed to inspire.

- Unparalleled service and accommodations
- Contemporary, luxury design
- Expert AV and technological integration
- Dynamic event facilities
- Business Center
- World-class food & beverage

PREMIER MUSIC & CULTURAL EXPERIENCES FOR MEETING & EVENTS

Hard Rock Hotels promise unique meeting experiences and spaces around the world, all fully equipped to create seamless, professional events – turning the ordinary into an “anything but beige” experience.

Our BREAKOUT programs are inspired by the most popular Hard Rock Hotel in-room amenity programs such as Sound of Your Stay® and Rock Om®. All designed to amplify your next meeting or event with curated music, memorabilia and brand experiences. We've partnered with the most innovative brand partners to develop experiences designed to inspire your team, strengthen bonds and create a deeper connection to your organization.



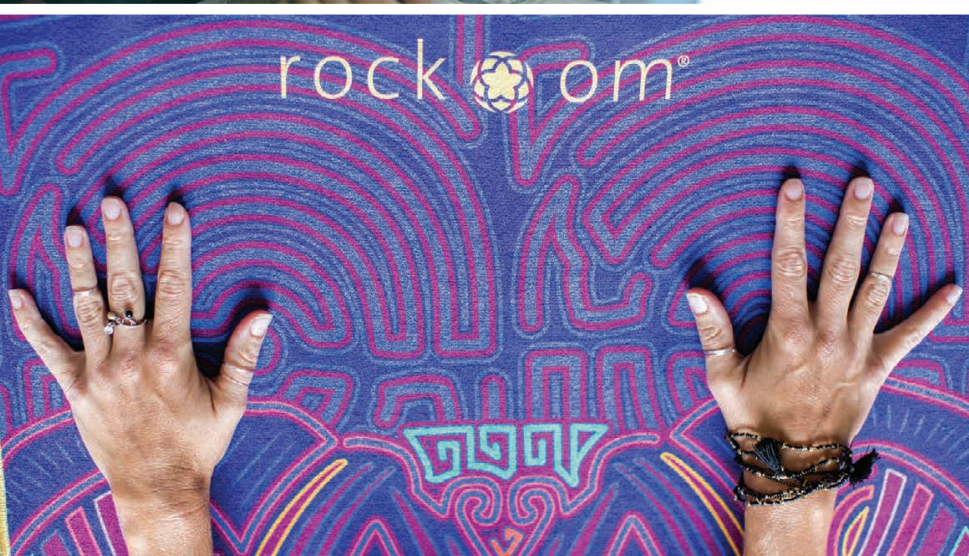

PREMIER MUSIC & CULTURAL EXPERIENCES FOR MEETINGS & EVENTS

Inspired by the most popular Hard Rock Hotel in-room amenity programs such as Sound of Your Stay® and Rock Om®, it's time to BREAKOUT and amplify these experiences for group events.

TRACKS®

SONG SLAM
TEAM ANTHEM
INSTA HITS
ROCKIN' RECEPTION

PICKS®

THE BAND:
GROUP GUITAR LESSONS

ROCK YOUR RIFF:
GUITAR ENSEMBLE

MIX®

LEARN TO BE A DJ
WINE RIFFS
SILENT DISCO

WAX®

SPIN ART

MEMORABILIA

TREASURES OF HARD ROCK TOUR
WE ARE THE CHAMPIONS GAME SHOW
SCAVENGER HUNT
TED-STYLE TALKS

MOTTOS

ALL IS ONE:
DRUM CIRCLE CREATING UNITY
THROUGH MUSIC

SOUNDBODY

ROCK OM® EXPERIENCE

BOOK THESE EXCLUSIVE PROGRAMS FOR YOUR NEXT EVENT.



WHEN THE
SPOTLIGHT IS OURS
THE MOMENT
IS YOURS

Every success story can trace its way back to an experience, one that changed those bold enough to be a part of it. These are BREAKOUT moments, our specialty. And on this stage is where you'll find yours.

So when you're ready to get serious about meetings, we're ready to make it happen. This is Hard Rock. And this is an event performance like no other.

Seminole Hard Rock Hotel & Casino Hollywood is home to the iconic Guitar Hotel, unveiled in October 2019 as part of a resort-wide expansion. With guitar faces, necks and brightly lit strings reaching 450 feet into the sky, The Guitar Hotel is one of the world's most recognizable landmarks.



ENJOY A TALENT THAT
SETS US APART





RECREATION

Boasting 18 acres of water, Seminole Hard Rock Hollywood is home to six pools across the integrated resort, including a stunning 13.5 acre pool at the Guitar Hotel. Hard Rock Hotel's award winning 4.5-acre pool is nestled into a towering rock mountain and provides a dramatic backdrop to a 182-foot waterslide. The pool features dramatic waterfalls and hot tubs.

Enjoy a setting that sets us apart

- Team building exercises at a large water lagoon that is nearly as long as three football fields and offers water activities such as paddle-boarding, kayaking and more.
- Breakout sessions with a view by reserving a poolside cabana equipped with wi-fi, personalized butler service & covered seating
- Networking event under the sun, poolside reception, entertainment and privacy options.





ROCK SPA® & SALON

Unwind like a true rock star with 21 ultra-lux treatment rooms surrounding a soothing green atrium with an overhead skylight. A full-service wellness-focused retreat, Rock Spa® & Salon includes a 3,300-square-foot fitness center outfitted with Technogym equipment and a 3,600-square-foot salon offer complete hair and nail services.

Breakout for relaxation

- Incentivize attendees with an array of treatments and services.
- Customize giveaways to amp up your guests.
- Reenergize and refuel pre or post meeting/event with a massage or facial.



DELUXE KING



ROOMS

DELUXE KING

Setting the stage for an encore performance, our 450-square-foot Deluxe King guest room is the perfect rock and roll retreat. Enjoy a sleek, modern sanctuary with plenty of amenities like state-of-the-art electronics and a leather-enhanced seating area. In the Deluxe King, you'll live and lounge in a room that's sensual and stylish.

DELUXE QUEEN

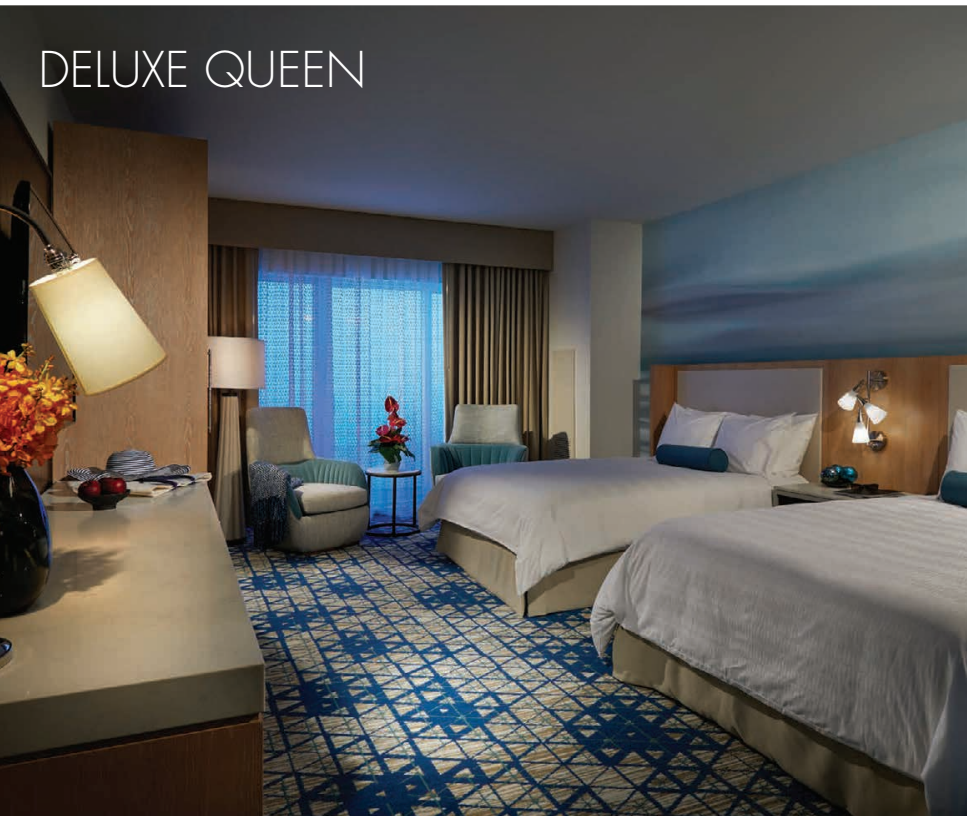

DELUXE QUEEN

In our Deluxe Queen, every single design detail has been orchestrated to deliver an authentic experience that rocks! This 450-square-foot contemporary haven features two queen-sized beds outfitted in the highest quality signature linens that are ideal for lounging around or just plain groovin'. High-end interactive touches and lush extras make this a perfect choice for two or more to play.

JUNIOR SUITE

Deserving of only the finest of rock royalty, our 550 sq. ft. Junior Suite is off the charts in luxury. Plug-in or chill out with high-definition options in your private digital domain. Sink into super soft signature bedding and stretch out with more room to move and groove amidst a variety of upgrades furnished in Hard Rock style.

PLATINUM SUITE

Surround yourself in the ultimate play space with our Platinum Suite spanning from 750 square feet. With a spotlight on lavish details, this suite exudes extravagance from the tip of its appointed headboard to the edge of its custom designed plush carpeting. This generously sized suite features a king bed, dining room table, digitally enhanced electronics and the finest views this side of South Florida.





EDIT THAT SAME OLD STORY



Nothing great ever came from expected.
So why escape just to fall into your everyday?
Experience fun, inventive, new ways to press play,
hit pause and break free from routine.
And do it with a rhythm that's sure to please.

THE SOUND OF YOUR STAY

Keep your groove going with our unique music programs:

TRACKS

Upon check in, you'll receive a link to stream our curated playlists on Spotify.

PICKS

Get something much cooler than ice delivered to your room. Borrow a Fender® electric guitar and headphones, free.

WAX

Partnering with Crosley, Hard Rock has amplified the in-room listening experience with a carefully curated collection of 10 iconic records. A Crosley turntable will keep the records spinning as guests find their groove at leisure.

CULINARY DISTINCTION PERFORMED DAILY



DINING

ABIKA

The wood fire grill restaurant showcases solid fuel, open fire grilling inspired by South Florida's unique, bold flavors. Abiaka celebrates live fire and solid fuel grilling, using both orangewood and white oak charcoal to bring the natural flavors of the ingredients to the forefront.

BEACH CLUB BAR & GRILL

Poolside dining done right, Beach Club serves up classic favorites with a tropical twist. Using locally sourced products, the menu features a mix of small plates and large shareable plates, and tropical takes on classic cocktails, perfect for beachside dining.

CIPRESSO

A contemporary twist on Italian-American fare, Cipresso offers a menu of time-honored classics based on old world traditions. Approachable dishes include creative, unique interpretations of handmade pasta, sauces, breads, pizza and specialty dishes.

COUNCIL OAK STEAKS & SEAFOOD

Sophisticated dining serving only the finest cuts of dry-aged U.S. prime beef and the freshest seafood from local waters. An award-winning wine selection and nightly live entertainment is offered in a separate lounge area.



HARD ROCK CAFE

Proud home to cafe number 119, the Hard Rock Cafe highlights a newly-designed open-kitchen concept with a contemporary menu of time-honored classics, and state-of-the-art entertainment and stage. A staple of the Hard Rock brand, music memorabilia line the walls telling stories of music past and present.

HARD ROCK SPORTS BAR

A next-level approach to sports and entertainment, Hard Rock Sports Bar highlights a massive wall of LED TVs providing 360 degrees of live sports action. Enjoy elevated classic American cuisine or crack open a cold one with friends while enjoying top sports action, or experience the thrill of live Blackjack at one of 12 tables located inside the Sports Bar.

KURO

Kuro is the resort's luxe and socially vibrant Japanese restaurant. The new-style Japanese concept features handcrafted cuisine and cocktails using both locally sourced and imported ingredients.

POOL BAR & GRILL

Set along an opulent 4.5 acre tropical lagoon-style pool, nestled into a towering rock mountain in the center of the pool is Pool Bar & Grill. Pool Bar offers a menu of refreshingly cool cocktails, food hot off the grill, tasty appetizers and refreshing salads.

RISE KITCHEN & DELI

Located at the base of The Guitar Hotel, Rise offers incredible views of the resort's pool lagoon through its floor-to-ceiling glass windows. The 24-hour contemporary American Diner/Deli celebrates fresh, seasonal produce with menu favorites and options for any palate.



BARS



CENTER BAR

Center Bar is the elevated showpiece bar in the heart of the casino featuring an 18-karat gold sculptural design that delineates the bar from the casino offering an intimate transition from the gaming floor. The menu at Center Bar is a Florida-based produce menu celebrating the state's offerings with unique cocktails created with fresh juices and herbs, craft beers from local partners and a boutique selection of curated wines.

L BAR

An intimate lounge and cocktail bar, L Bar offers handcrafted cocktails using fresh, seasonal produce, house-made syrups and inventive techniques for a menu that's progressive yet nostalgic and ever-evolving. Offerings include classic and contemporary drinks, a specialized menu of premium tequilas and unaged, unoaked mezcals, as well as craft and imported beer, wine and champagne.



OCULUS BAR

Located centrally in The Guitar Hotel lobby, Oculus Bar features an open layout giving guests prime sightlines to the resort's water attraction, the Oculus. Oculus Bar offers a unique take on a classic wine bar with a focus on curated wines and signature cocktails where aperitifs, amaros and vermouths take center stage. On draught are both local craft beer and unique imported brands. From the wrap-around bar to plush lounge seating, there's not a bad seat in the house.

PROPERTY OVERVIEW

UNWIND

- Three hotel tower experience: 1,271 total rooms
- 638 luxury guestrooms and suites in the 34-story Guitar Hotel
- 168 luxury guestrooms and suites in the seven-story Oasis Tower at Seminole Hard Rock Hotel & Casino with swim-up ground level suites
- 465 luxury guestrooms and suites in the 12-story Hard Rock Hotel
- Accommodations span from 430 – 4,000 square feet
- 42,000-square-foot Rock Spa® & Salon with 21 treatment rooms
- 18 acres of recreational waterscape that includes pools and a lagoon

ENTERTAINMENT

- 7,000-capacity, state-of-the-art Hard Rock Live venue
- 26,000 square feet of boutique storefronts at The Shoppes at the Guitar Hotel
- Three-level DAER South Florida complex including DAER Nightclub, DAER Dayclub and Rooftop Live
- Entice Ultra Lounge 7,500-square-foot nightclub with multiple full bars and lounge seating
- Hard Rock Sports Bar offers 360 degrees of sports action with live gaming and classic sports fare

PLAY

- 150,000-square-foot casino floor
- More than 2,800 of the most popular slots
- 208 table games
- 45-table poker room
- High-Limit slots and tables
- Non-smoking gaming

EAT & DRINK

- Abiaka
- Aubi & Ramsa
- BAE Korean Grill
- Beach Club Bar & Grill
- Center Bar
- Ciproso
- Constant Grind
- Council Oak Steaks & Seafood
- Davidoff Cigar Lounge
- Hard Rock Cafe
- Kuro
- L Bar
- Marky's Caviar Lounge
- Oculus Bar
- PLA Sports Bar
- Pool Bar & Grill
- Rise Kitchen & Deli
- The Bōl

MEET

Featuring 120,000 square feet of meeting space, including a 38,000-square-foot, carpeted exhibition hall - perfect for hosting tradeshow, association conventions, large corporate groups and social events. Adjacent is a luxe pre-function space that features vaulted ceilings, chandeliered ballrooms and marbled atriums. This opulent and sophisticated setting offers the perfect location for the most productive business events and elegant social affairs. The flexible meeting space can be reconfigured to accommodate groups as large as 5,000 attendees or smaller, more intimate meetings for 15 individuals, and everything in between.

The integrated resort is located on 87 acres of tribal land and supported by a world-class team of event, culinary and service professionals ensuring every event is executed with precision and poise.

HIGHLIGHTS

- Easy to navigate meeting space, all first floor level
- Dedicated loading dock at street level
- Business Center
- In-house audio/visual team
- Complimentary self-parking. Valet options also available
- Complimentary resort-wide Wi-Fi

REGISTRATION
DESK



TERRACE
BALLROOM



SEMINOLE
BALLROOM

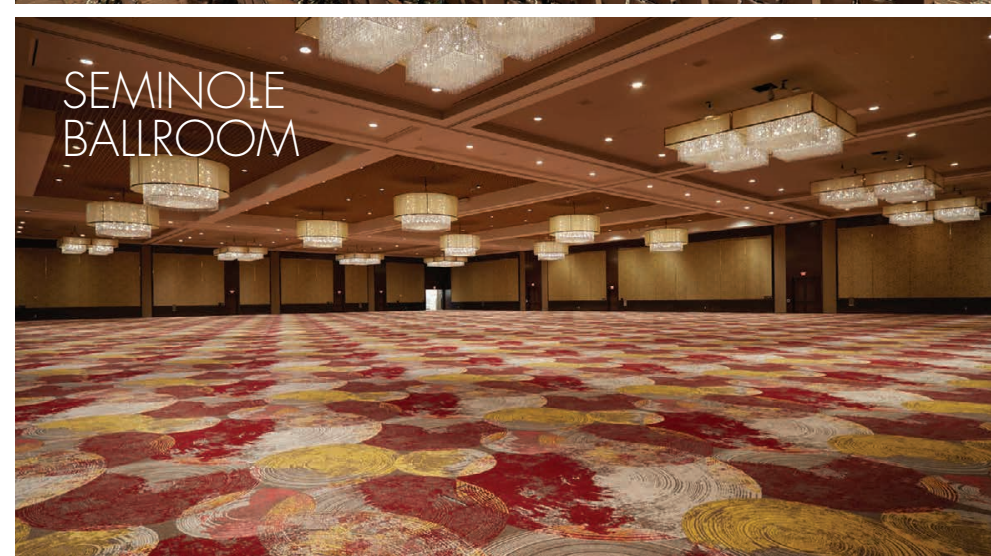



The SAFE + SOUND program has been developed by a team of hospitality and gaming experts in collaboration with worldwide health and sanitation specialists, such as Ecolab and NSF. It also includes directives of key agencies, such as the World Health Organization (WHO) and the U.S. Center for Disease Control and Prevention (CDC). SAFE + SOUND is focused on enhanced cleaning practices, social interactions and workplace protocols, while ensuring transparency through the Guest and Team Member journey.

As part of the program, every Hard Rock Hotel & Casino around the world is required to

PASS THE SAFE+SOUND 262 POINT INSPECTION

independently assessed by NSF. We look forward once more to welcoming through our doors the millions of Hard Rock fans around the world, in the safest environment.

To learn more [click here](#).

MEETING SPACES

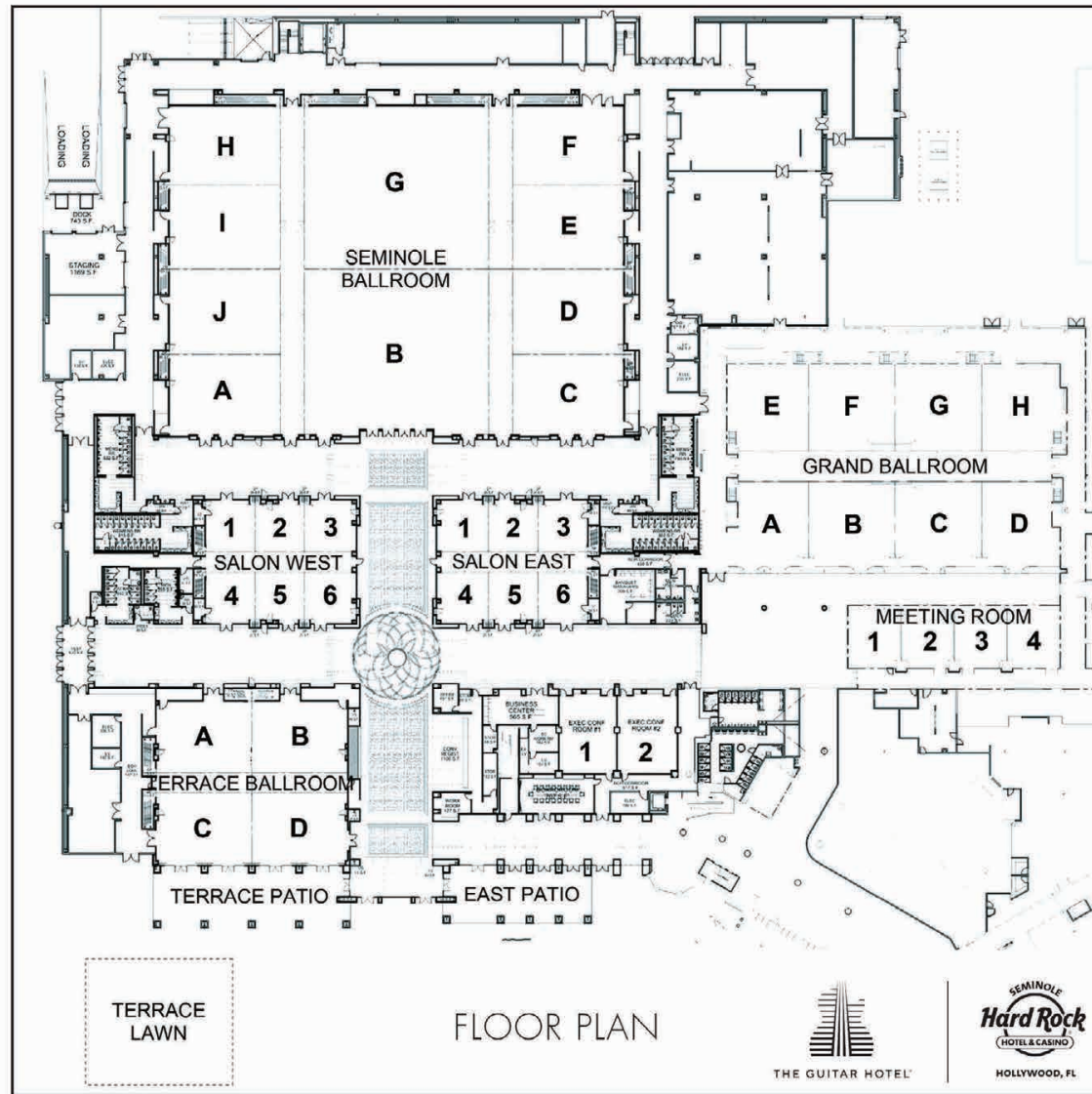

ROOM	DIMENSIONS	SQUARE FEET	BANQUETS	THEATER	CLASSROOM	RECEPTION	CONFERENCE	CEILING HEIGHT
GRAND BALLROOM	160x100	16000	1080	1700	1080	1680		20'
Grand Ballroom A	40x42	1680	110	150	100	150	44	20'
Grand Ballroom B	40x42	1680	110	150	100	150	44	20'
Grand Ballroom C	40x42	1680	110	150	100	150	44	20'
Grand Ballroom D	40x42	1680	110	150	100	150	44	20'
Grand Ballroom E	40x42	1680	110	150	100	150	44	20'
Grand Ballroom F	40x42	1680	110	150	100	150	44	20'
Grand Ballroom G	40x42	1680	110	150	100	150	44	20'
Grand Ballroom H	40x42	1680	110	150	100	150	44	20'
Grand Ballroom A/M	40x58	2320	150	220	120	200		20'
Grand Ballroom B/M	40x58	2320	150	210	130	200		20'
Grand Ballroom C/M	40x58	2320	150	200	130	200		20'
Grand Ballroom D/M	40x58	2320	140	200	125	200		20'
Grand Ballroom E/M	40x58	2320	140	200	125	200		20'
Grand Ballroom F/M	40x58	2320	150	200	125	200		20'
Grand Ballroom G/M	40x58	2320	150	200	125	200		20'
Grand Ballroom H/M	40x58	2320	140	180	110	200		20'
Grand Ballroom A/B	80x42	3360	220	320	170	225		20'
Grand Ballroom B/C	80x42	3360	220	320	170	225		20'
Grand Ballroom C/D	80x42	3360	220	300	170	225		20'
Grand Ballroom E/F	80x42	3360	200	300	170	225		20'
Grand Ballroom F/G	80x42	3360	220	300	170	225		20'
Grand Ballroom G/H	80x42	3360	200	320	170	225		20'
Grand Ballroom A/B/M	80x58	4640	280	410	240	325		20'
Grand Ballroom B/C/M	80x58	4640	280	410	240	325		20'
Grand Ballroom C/D/M	80x58	4640	280	410	240	325		20'
Grand Ballroom E/F/M	80x58	4640	280	410	240	325		20'
Grand Ballroom F/G/M	80x58	4640	280	410	240	325		20'
Grand Ballroom G/H/M	80x58	4640	280	410	240	325		20'
Grand Ballroom A/B/C	120x42	5040	330	480	280	410		20'
Grand Ballroom B/C/D	120x42	5040	330	480	280	410		20'
Grand Ballroom E/F/G	120x42	5040	330	480	280	410		20'
Grand Ballroom A/B/C/M	120x58	6960	400	540	340	500		20'
Grand Ballroom B/C/D/M	120x58	6960	400	540	340	500		20'
Grand Ballroom E/F/G/M	120x58	6960	400	540	340	500		20'
Grand Ballroom F/G/H/M	120x58	6960	400	520	340	500		20'

*Estimated MAX capacities do not account for head tables, stages, dance floors or audio visual. Ceiling heights are measured from chandeliers.

ROOM	DIMENSIONS	SQUARE FEET	BANQUETS	THEATER	CLASSROOM	RECEPTION	CONFERENCE	CEILING HEIGHT
Grand Ballroom A/B/C/D	160x42	6720	400	540	340	500		20'
Grand Ballroom E/F/G/H	160x42	6720	380	510	320	500		20'
Grand Ballroom A/B/C/D/M	160x58	9280	540	875	560	750		20'
Grand Ballroom E/F/G/H/M	160x58	9280	540	825	540	750		20'
Grand Ballroom A/E/M	40x100	4000	220	350	200	275		20'
Grand Ballroom B/F/M	40x100	4000	240	380	220	275		20'
Grand Ballroom C/G/M	40x100	4000	240	380	220	275		20'
Grand Ballroom D/H/M	40x100	4000	220	350	200	275		20'
Grand Ballroom A/B/E/F/M	80x100	8000	540	850	540	840		20'
Grand Ballroom B/C/F/G/M	80x100	8000	540	850	540	840		20'
Grand Ballroom C/D/G/H/M	80x100	8000	540	850	540	840		20'
Grand Ballroom A/B/C/E/F/G/M	120x100	12000	740	1200	800	1200		20'
Grand Ballroom B/C/D/F/G/H/M	120x100	12000	740	1200	800	1200		20'
Grand Ballroom Corridor	160x16	2560						20'
Grand Ballroom Pre-Function		4878						
MEETING ROOM	106x30	3180	200	280	148	200		13'
Meeting Room 1	26x30	780	50	70	37	50	24	13'
Meeting Room 2	26x30	780	50	70	37	50	24	13'
Meeting Room 3	26x30	780	50	70	37	50	24	13'
Meeting Room 4	26x30	780	50	70	37	50	24	13'
Meeting Room 1 & 2	52x30	1560	100	140	74	100	40	13'
Meeting Room 2 & 3	52x30	1560	100	140	74	100	40	13'
Meeting Room 3 & 4	52x30	1560	100	140	74	100	40	13'
Meeting Room 1/2/3	78x30	2340	150	210	111	150	60	13'
Meeting Room 2/3/4	78x30	2340	150	210	111	150	60	13'
OUTDOOR FUNCTION POOL DECK								
Outdoor Function Pool Deck 1								
Outdoor Function Pool Deck 2								
Outdoor Function Pool Deck 3								
Outdoor Function Pool Deck 4								
SEMINOLE BALLROOM	226x166	37516	2490	3600	1500	5000		26'
Seminole Ballroom A	55x42	2310	150	180	100	200		26'
Seminole Ballroom B	90x84	7560	500	640	320	720		26'
Seminole Ballroom C	55x42	2310	120	190	100	200		26'
Seminole Ballroom D	55x42	2310	150	200	100	210		26'
Seminole Ballroom E	55x42	2310	150	200	100	210		26'
Seminole Ballroom F	55x42	2310	120	180	100	200		26'

*Estimated MAX capacities do not account for head tables, stages, dance floors or audio visual. Ceiling heights are measured from chandeliers.

ROOM	DIMENSIONS	SQUARE FEET	BANQUETS	THEATER	CLASSROOM	RECEPTION	CONFERENCE	CEILING HEIGHT
Seminole Ballroom G	90x84	7560	500	640	320	780		26'
Seminole Ballroom H	55x42	2310	120	180	88	200		26'
Seminole Ballroom I	55x42	2310	150	200	96	210		26'
Seminole Ballroom J	55x42	2310	150	200	96	210		26'
Seminole Ballroom A/J	55x84	4620	250	400	188	420		26'
Seminole Ballroom A/J/I	55x126	6930	380	540	284	500		26'
Seminole Ballroom A/J/I/H	55x166	9130	500	900	373	840		26'
Seminole Ballroom A/B/J/M	171x84	14364	740	1200	510	1100		26'
Seminole Ballroom A/B/J/G/H/I/M	171x166	28386	1500	2400	1017	2300		26'
Seminole Ballroom A/B/C/D/J	226x84	18984	1080	1700	698	2000		26'
Seminole Ballroom B/G	90x166	14940	1288	1600	644	1800		26'
Seminole Ballroom B/C/D/M	171x84	14364	740	1250	510	1100		26'
Seminole Ballroom B/C/D/E/F/G/M	171x166	28386	1500	2400	1017	2300		26'
Seminole Ballroom C/D	55x84	4620	250	400	188	420		26'
Seminole Ballroom C/D/E	55x126	6930	380	540	284	500		26'
Seminole Ballroom C/D/E/F	55x166	9130	500	900	373	840		26'
Seminole Ballroom West Corridor	13x166	2158						
Seminole Ballroom East Corridor	13x166	2158						
8'x10' Booths - 220								
10'x10' Booths - 180								
Seminole Ballroom Pre-Function	259x29	7511				800		
SALON WEST	75x61	4575	250	400	200	300	80	20'
Salon West 1	24x26	624	40	50	26	50	15	20'
Salon West 2	24x26	624	40	50	26	50	15	20'
Salon West 3	24x26	624	40	50	27	50	15	20'
Salon West 4	24x26	624	40	50	26	50	15	20'
Salon West 5	24x26	624	40	50	26	50	15	20'
Salon West 6	24x26	624	40	50	27	50	15	20'
Salon West 1,2	48x26	1248	80	100	52	100	30	20'
Salon West 1,2,3	75x26	1950	120	170	80	140	45	20'
Salon West 2,3	48x26	1248	80	100	53	100	30	20'
Salon West 4,5,6	75x26	1950	130	180	90	140	48	20'
Salon West 4,5	48x26	1248	80	100	52	100	30	20'
Salon West 5,6	48x26	1248	80	100	53	100	30	20'
Salon West Corridor	75x9	675						
Salon West Pre-Function	132x31	4092						

*Estimated MAX capacities do not account for head tables, stages, dance floors or audio visual. Ceiling heights are measured from chandeliers.

ROOM	DIMENSIONS	SQUARE FEET	BANQUETS	THEATER	CLASSROOM	RECEPTION	CONFERENCE	CEILING HEIGHT
SALON EAST	75x61	4575	250	400	200	300	80	20'
Salon East 1	24x26	624	40	50	26	50	15	20'
Salon East 2	24x26	624	40	50	26	50	15	20'
Salon East 3	24x26	624	40	50	26	50	15	20'
Salon East 4	24x26	624	40	50	26	50	15	20'
Salon East 5	24x26	624	40	50	26	50	15	20'
Salon East 6	24x26	624	40	50	26	50	15	20'
Salon East 1,2	48x26	1248	80	100	52	100	30	20'
Salon East 1,2,3	75x26	1950	120	170	80	140	45	20'
Salon East 2,3	48x26	1248	80	100	52	100	30	20'
Salon East 4,5,6	75x26	1950	120	170	80	140	45	20'
Salon East 4,5	48x26	1248	80	100	52	100	30	20'
Salon East 5,6	48x26	1248	80	100	52	100	30	20'
Salon East Corridor	75x9	675						
Salon East Pre-Function	134x31	4154						
TERRACE BALLROOM	95x81	7695	500	640	520	600	186	25'
Terrace Ballroom A	47x35	1645	120	150	100	150	40	25'
Terrace Ballroom B	47x35	1645	120	150	100	150	40	25'
Terrace Ballroom C	47x35	1645	110	140	90	140	36	25'
Terrace Ballroom D	47x35	1645	110	140	90	140	36	25'
Terrace AB	95x35	3325	220	320	170	225		25'
Terrace CD	95x35	3325	220	320	170	225		25'
Terrace AC	47x81	3807	220	320	170	225		25'
Terrace BD	47x81	3807	220	320	170	225		25'
Terrace Corridor	95x11	1045						
Terrace Patio	97x31	3007	180	250		230		
Terrace Lawn	85x50	4250	220	380		300		
Terrace Pre-Function	35x103	3605						
Rotunda	35x31	1085						
Executive Conference Room 1	25x38	950	70	90	48	100	28	10'
Executive Conference Room 2	27x38	1026	70	90	48	100	28	10'
Executive Board Room	37x19	703					18	
East Patio	73x29	2117	140	160		180		
CONFERENCE REGISTRATION DESK	28'L							
Conference Registration Office		151						
Conference Registration Work Room		177						

*Estimated MAX capacities do not account for head tables, stages, dance floors or audio visual. Ceiling heights are measured from chandeliers.



BREAKOUT

HOLLYWOOD | FL

STEP OUTSIDE AND STEP IT UP

Stretching 450 feet into the sky, it's hard to miss The Guitar Hotel when you touch down at Fort Lauderdale Hollywood International Airport only 8 miles away. From your hotel room you're only a few minutes away from the pristine white sand and warm turquoise blue ocean of Florida's famous beaches. You'll feel the stress of the world melt away as your toes flirt with the sand and you become immersed in the soothing, gentle waves of the Atlantic Ocean.

The area has something for everyone...Everglades National Park, the largest subtropical wilderness in the US; Sawgrass Mills, the largest retail outlet destination in the US; Hollywood Beach Boardwalk, a 2.5 mile pedestrian promenade and Wynwood Art District, home to art galleries & museums.



Known as the “Unconquered” Seminole Tribe of Florida, because it never signed a peace treaty with the United States government, the Seminole Tribe has long been recognized for its gaming industry innovations and success. It was the first Indian Tribe in North America to open a high-stakes bingo hall and casino, which debuted in 1979 and became the forerunner of the Indian Gaming movement. The original high stakes bingo hall is now the Seminole Classic Casino.

The Seminole Tribe expanded its gaming operations throughout the 1980s and 1990s with the opening of Seminole Brighton Casino, Seminole Casino Immokalee, Seminole Casino Coconut Creek, and Seminole Casino Tampa, which was transformed into Seminole Hard Rock Hotel & Casino Tampa in 2004. That same year, the Seminole Tribe opened Seminole Hard Rock Hotel & Casino Hollywood.

The Seminole Tribe acquired Hard Rock International in March 2007 for \$965 million, making the Seminoles the first North American Indian Tribe to purchase a major international corporation. Through its Seminole Hard Rock Entertainment subsidiary, the Tribe continues its global control of Hard Rock, one of the world’s most recognized restaurant, hotel and casino brands.

In October 2019, Seminole Gaming capped a \$2.1 billion capital investment program with the grand openings of the Guitar Hotel at Seminole Hard Rock Hotel & Casino Hollywood and a major expansion of Seminole Hard Rock Hotel & Casino Tampa. They are among the most successful casino complexes in the world.



THE GUITAR HOTEL®



HOLLYWOOD, FL

1 SEMINOLE WAY | HOLLYWOOD, FL 33314 | HARDROCKHOLLY.COM | 800.937.0156