

# MIRAGE CONVENTION AREA



## FREIGHT DOORS

### LOCATION

### W X H

NORTHWEST DOOR

12' x 15'

NORTH DOOR

12' x 15'

SOUTHEAST DOOR

25' x 16'

SOUTHWEST DOOR

12' x 15'

WEST DOOR

10' x 10'

MONTEGO DOOR

12' x 15'

GRAND BALLROOM B DOOR

9' x 14'

GRAND BALLROOM D DOOR

9' x 14'

# Mirage Events Center Dimensions

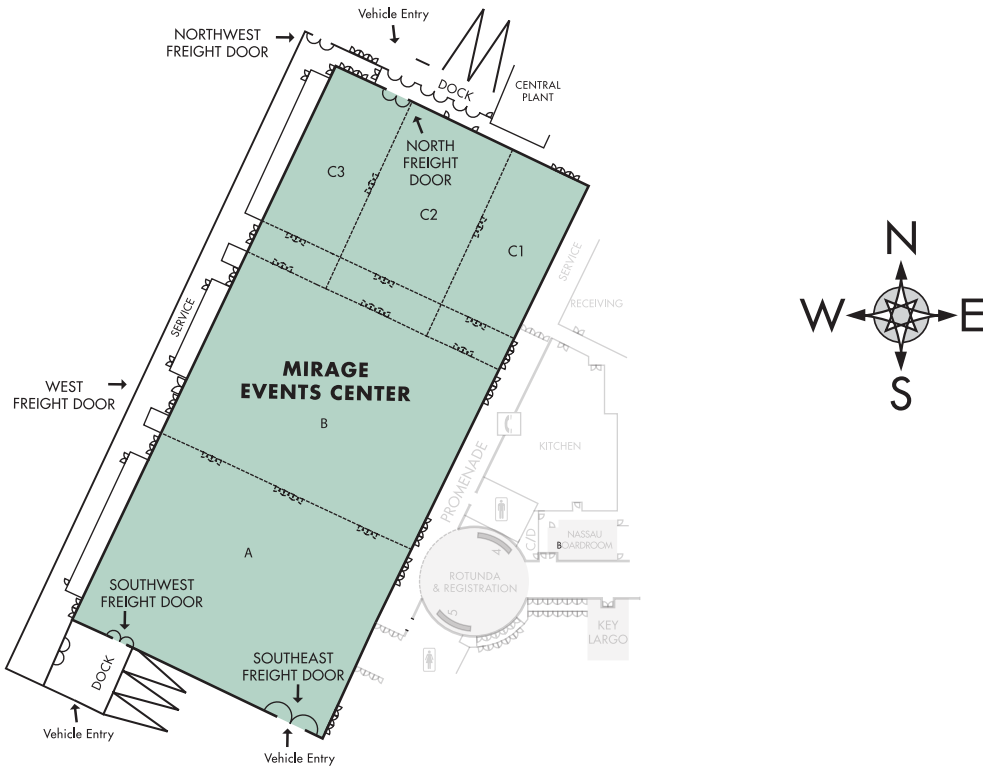

## Dimensions

	Square Feet	Dimensions L & W	Ceiling Height
Mirage Event Center	89,400	447' x 200'	30'
Mirage Event Center A	29,750	149' x 200'	30'
Mirage Event Center B	30,000	149' x 200'	30'
Mirage Event Center C	29,750	149' x 200'	30'
Mirage Event Center C1	6,545	119' x 55'	30'
Mirage Event Center C2	10,710	119' x 90'	30'
Mirage Event Center C3	6,545	119' x 55'	30'
Mirage Event Center C1-C3	23,800	119' x 200'	30'

## Capacities Part 1

	Mirage Event Center	A	B	C
Theatre	8,650	2,745	2,825	2,745
School Room	5,800	1,730	1,750	1,730
Hollow Square	N/A	N/A	N/A	N/A
U-Shape	N/A	N/A	N/A	N/A
Cone	N/A	N/A	N/A	N/A
Cocktail reception	6,000	2,100	2,100	2,000
Banquet	5,900	2,000	2,000	1,900
8'x10' Exhibits	540	180	180	180
10'x10' Exhibits	508	165	165	165

## Capacities Part 2

	C1	C2	C3	C1-C3
Theatre	545	935	545	2,020
School Room	360	660	360	1,380
Hollow Square	125	160	125	N/A
U-Shape	110	125	110	N/A
Cone	N/A	N/A	N/A	N/A
Cocktail reception	435	720	435	1,600
Banquet	400	700	400	1,520
8'x10' Exhibits	40	67	40	140
10'x10' Exhibits	32	58	32	115

## Rotunda

Dimensions	Square Feet	Dimensions L & W	Ceiling Height
Rotunda	5,027	N/A	N/A
<b>Capacities</b>	<b>Rotunda</b>		
Theatre	N/A		
School Room	N/A		
Hollow Square	N/A		
U-Shape	N/A		
Cone	N/A		
Cocktail reception	N/A		
Banquet	N/A		
8'x10' Exhibits	N/A		
10'x10' Exhibits	N/A		

# Mirage Grand Ballroom Dimensions

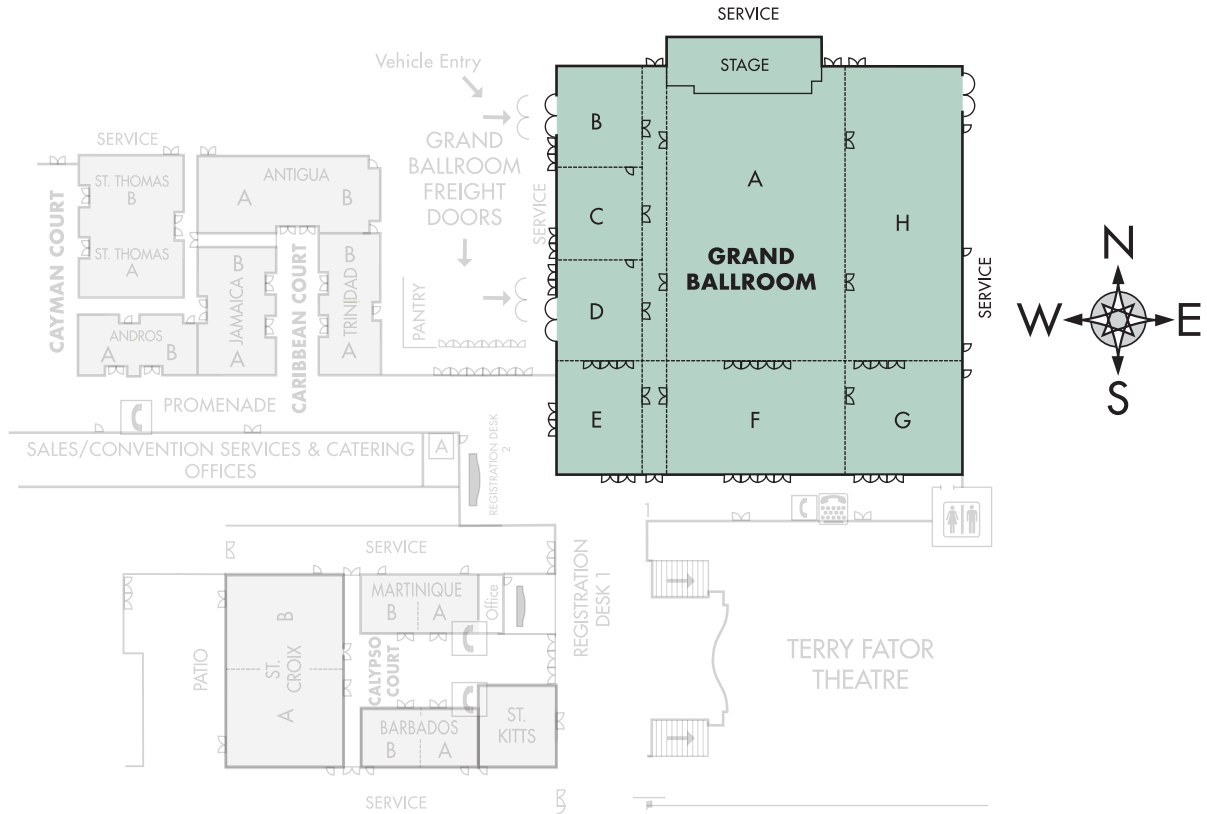

## Dimensions

	Square Feet	Dimensions L & W	Ceiling Height
Grand Ballroom	40,000	200' x 200'	24'
Grand Ballroom A	12,232	139' x 88'	24'
Grand Ballroom B	1,980	45' x 44'	24'
Grand Ballroom C	1,980	45' x 44'	24'
Grand Ballroom D	2,200	50' x 44'	24'
Grand Ballroom E	2,640	60' x 44'	24'
Grand Ballroom F	5,280	60' x 88'	24'
Grand Ballroom G	3,360	60' x 56'	24'
Grand Ballroom H	7,784	139' x 56'	24'
Recessed Stage	2,652	78' x 34'	N/A

## Capacities Part 1

	Grand Ballroom	A	B	C	D
Theatre	3,600	1,080	170	170	180
School Room	2,200	760	110	110	130
Hollow Square	N/A	140	55	55	60
U-Shape	N/A	110	45	45	45
Cone	N/A	110	35	35	40
Cocktail reception	2,700	900	130	130	140
Banquet	2,550	770	110	110	120
8'x10' Exhibits	245	70	10	10	10
10'x10' Exhibits	210	65	10	10	10

## Capacities Part 2

	E	F	G	H	Recessed Stage
Theatre	205	465	280	650	N/A
School Room	145	285	190	400	N/A
Hollow Square	70	100	70	110	N/A
U-Shape	55	80	55	100	N/A
Cone	50	70	50	110	N/A
Cocktail reception	180	360	225	520	N/A
Banquet	150	300	200	440	N/A
8'x10' Exhibits	12	26	17	45	N/A
10'x10' Exhibits	12	26	13	32	N/A

# Mirage Andros Room Dimensions

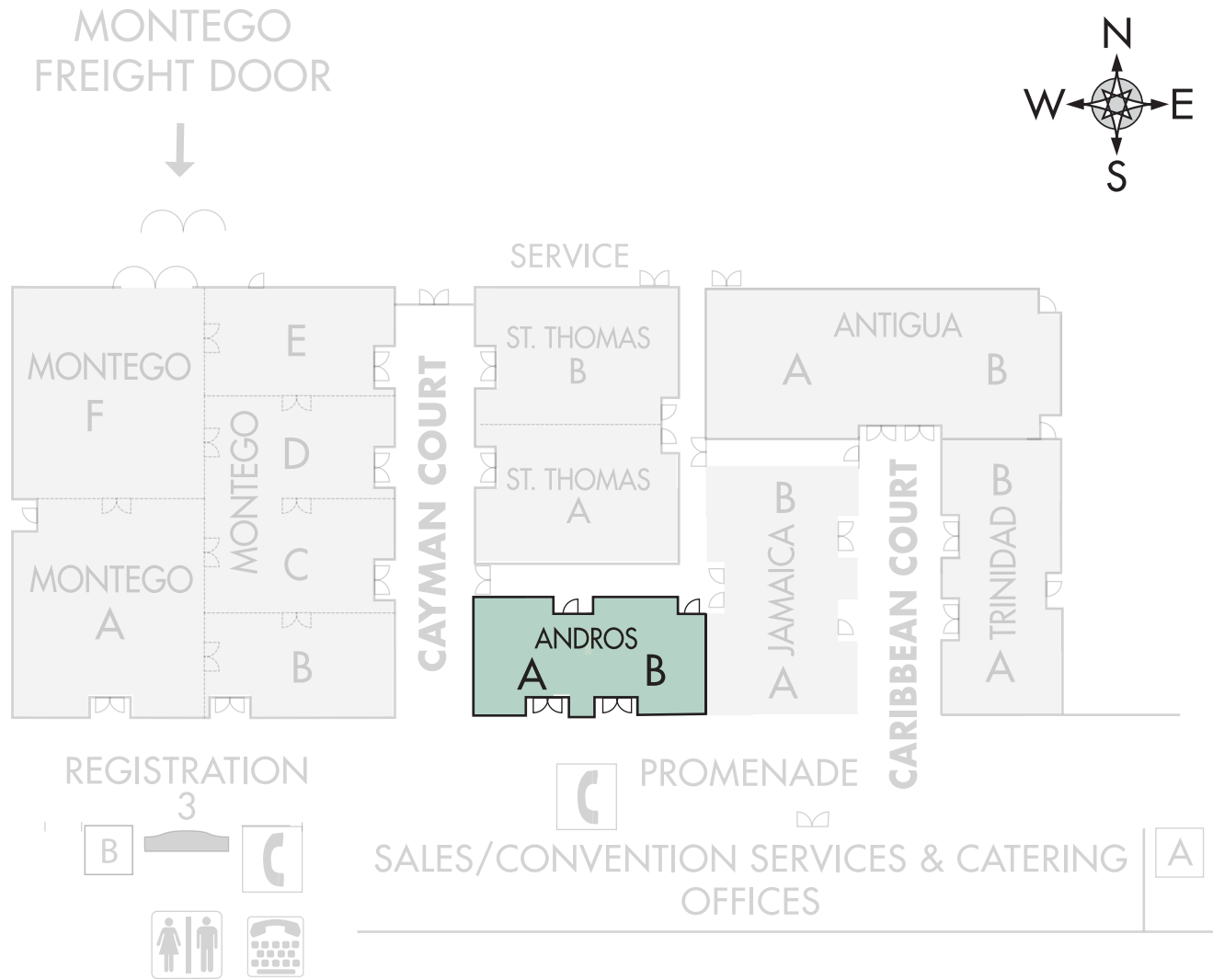

<b>Andros</b>			
<b>Dimensions</b>	<b>Andros A &amp; B</b>	<b>A</b>	<b>B</b>
Square Feet	1,829	868	961
Dimensions L x W	59' x 31'	28' x 31'	31' x 31'
Ceiling Height	14'	14'	14'
<b>Capacities</b>	<b>Andros A &amp; B</b>	<b>A</b>	<b>B</b>
Theatre	135	55	65
School Room	90	35	50
Hollow Square	60	30	35
U-Shape	55	25	25
Cone	50	25	25
Cocktail reception	105	50	55
Banquet	80	30	40
8'x10' Exhibits	N/A	N/A	N/A
10'x10' Exhibits	N/A	N/A	N/A

# Mirage Jamaica Room Dimensions

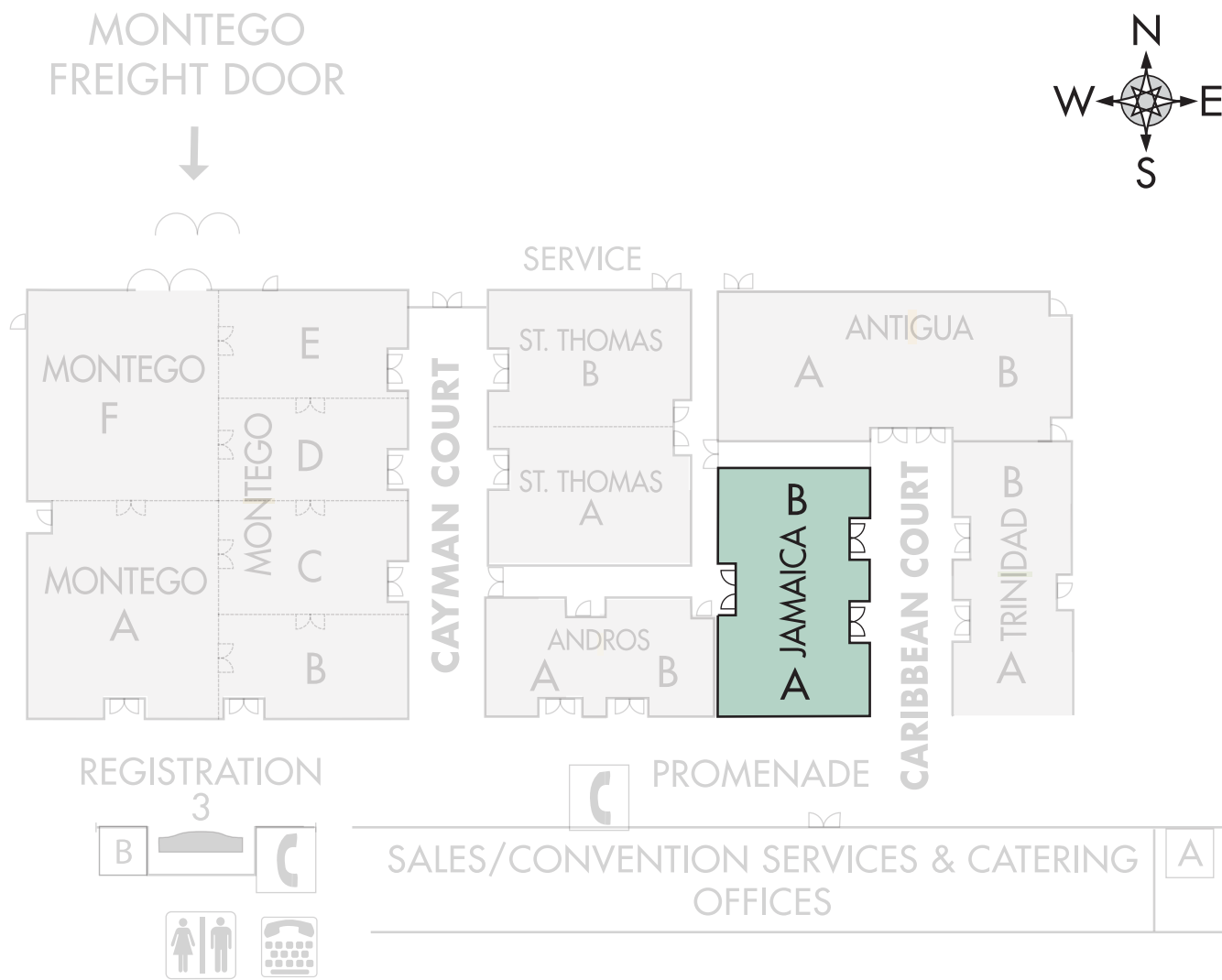

## Jamaica

Dimensions	Jamaica A & B	A	B
Square Feet	2,457	1,365	1,092
Dimensions L x W	63' x 39'	35' x 39'	28' x 39'
Ceiling Height	14'	14'	14'
Capacities	Jamaica A & B	A	B
Theatre	175	90	80
School Room	110	60	55
Hollow Square	65	40	40
U-Shape	55	30	30
Cone	55	30	30
Cocktail reception	175	90	65
Banquet	110	60	50
8'x10' Exhibits	N/A	N/A	N/A
10'x10' Exhibits	N/A	N/A	N/A

# Mirage Key Largo Dimensions

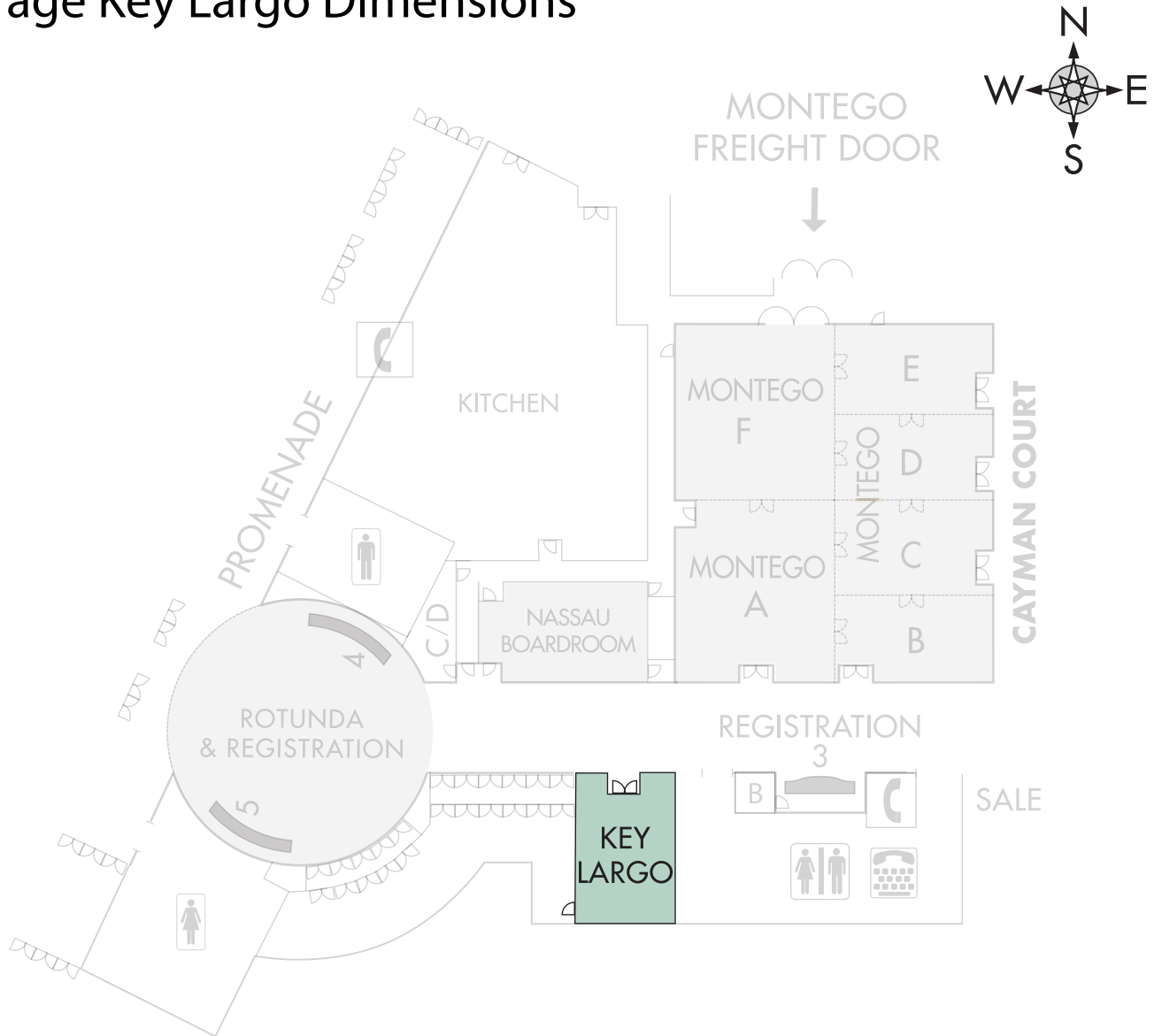

## Key Largo

### Dimensions

Square Feet 1,333 Dimensions L x W

Ceiling Height

### Capacities

Theatre

School Room

Hollow Square

U-Shape

Cone

Cocktail reception

Banquet

8'x10' Exhibits

10'x10' Exhibits

### Key Largo

43' x 31'

14'

### Key Largo

115

75

40

30

35

85

60

N/A

N/A

# Mirage Montego Room Dimensions

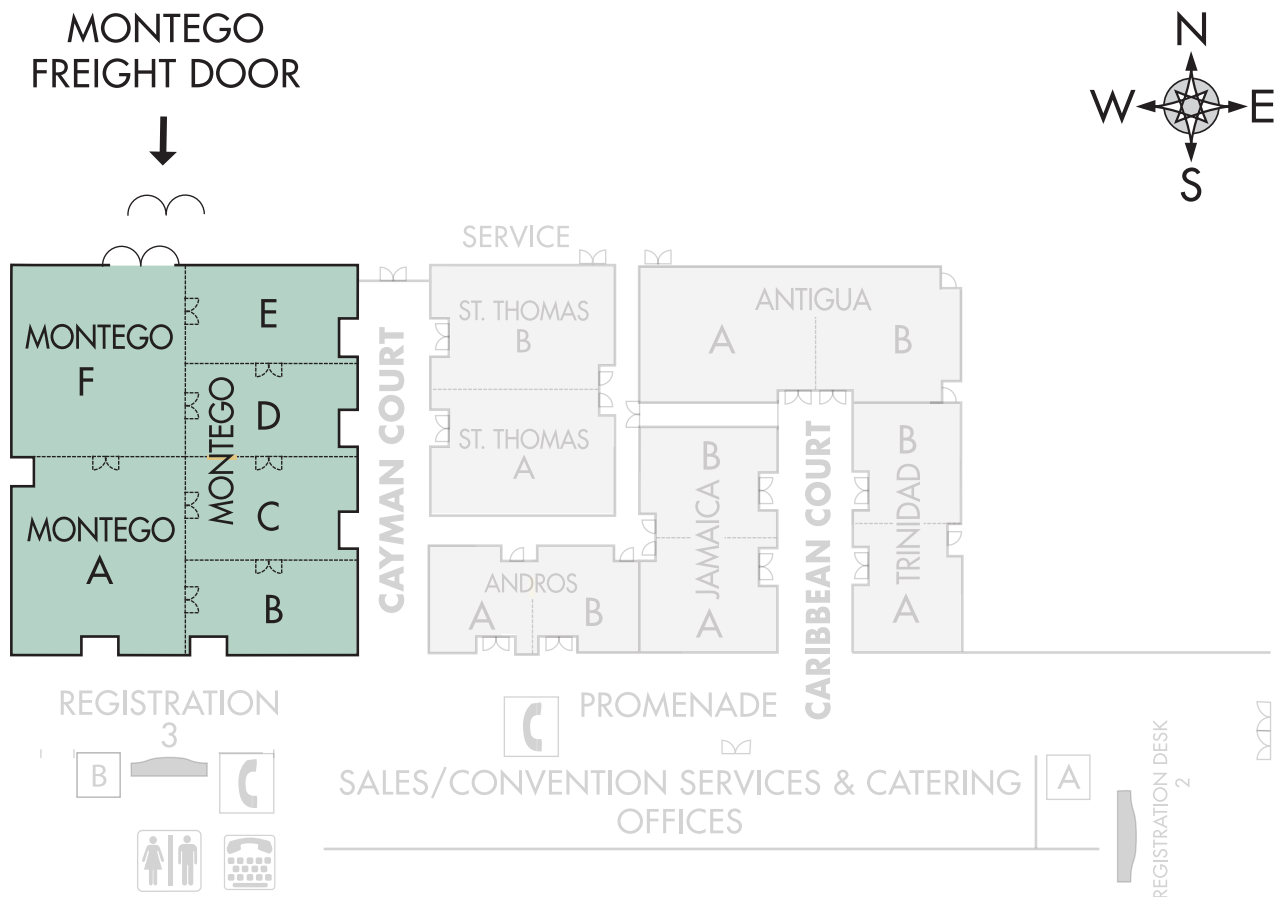

## Montego

Dimensions	Montego A & B	A	B
Montego	10,573	109' x 97'	20'
Montego A	2,688	56' x 48'	20'
Montego B	1,300	27' x 50'	20'
Montego C	1,400	28' x 50'	20'
Montego D	1,188	27' x 50'	20'
Montego E	1,350	27' x 50'	20'
Montego F	2,544	53' x 48'	20'

Capacities	Montego	A	B	C	D	E	F
Theatre	700	170	90	110	105	90	170
School Room	525	140	65	85	85	75	125
Hollow Square	140	65	40	50	50	40	65
U-Shape	115	55	30	40	40	35	55
Cone	95	50	35	35	35	35	50
Cocktail reception	650	160	80	85	75	80	160
Banquet	560	130	60	60	60	60	130
8'x10' Exhibits	52	N/A	N/A	N/A	N/A	N/A	N/A
10'x10' Exhibits	40	N/A	N/A	N/A	N/A	N/A	N/A

# Mirage Nassau Boardroom Dimensions

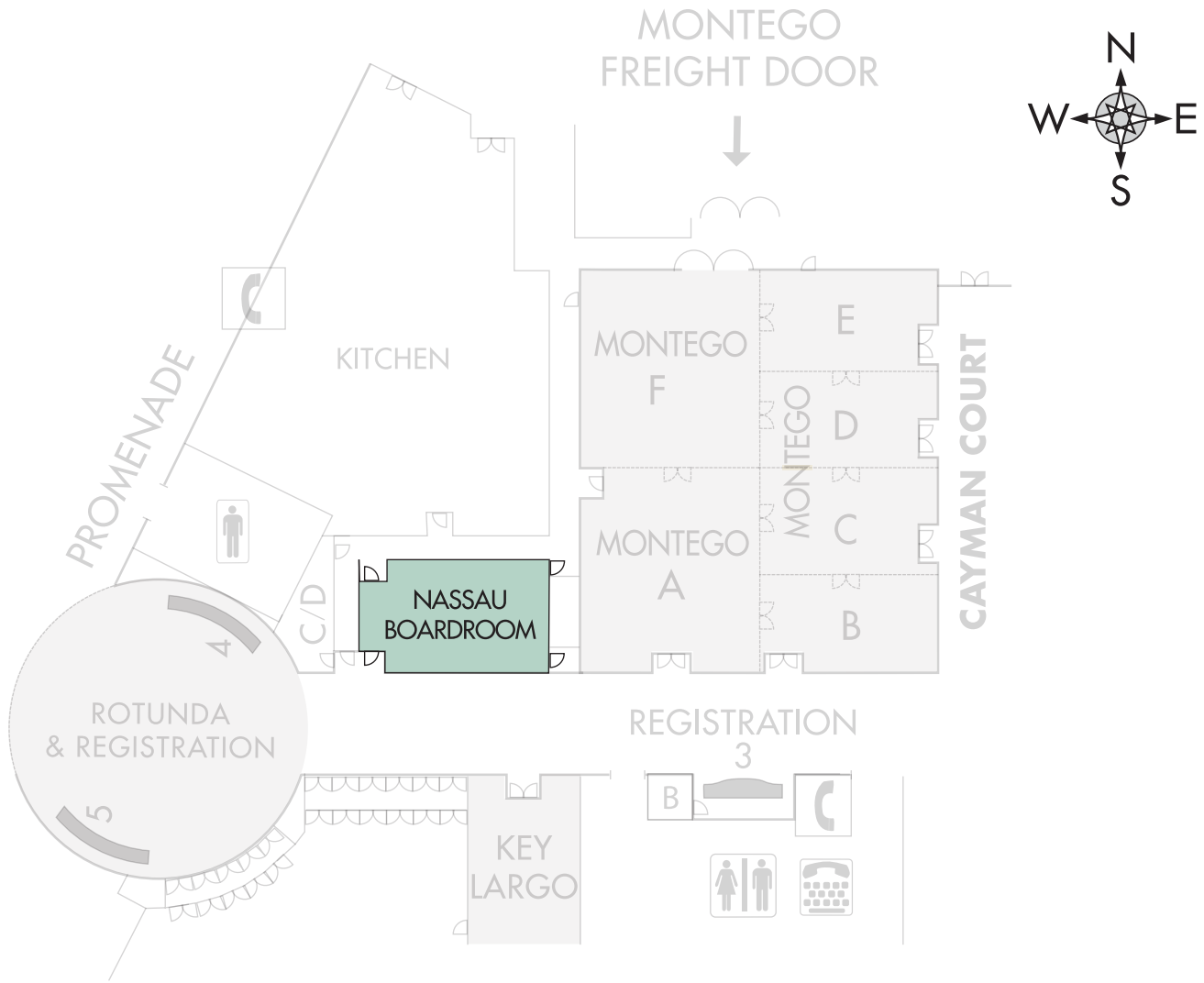

## Nassau

### Dimensions

### Nassau Boardroom

Square Feet

1,829

Dimensions L x W

59' x 31'

Ceiling Height

12'-6"

### Capacities

### Nassau Boardroom

Theatre

N/A

School Room

N/A

Hollow Square

N/A

U-Shape

N/A

Cone

N/A

Cocktail reception

N/A

Banquet

N/A

8'x10' Exhibits

N/A

10'x10' Exhibits

N/A



# Mirage St. Thomas Room Dimensions

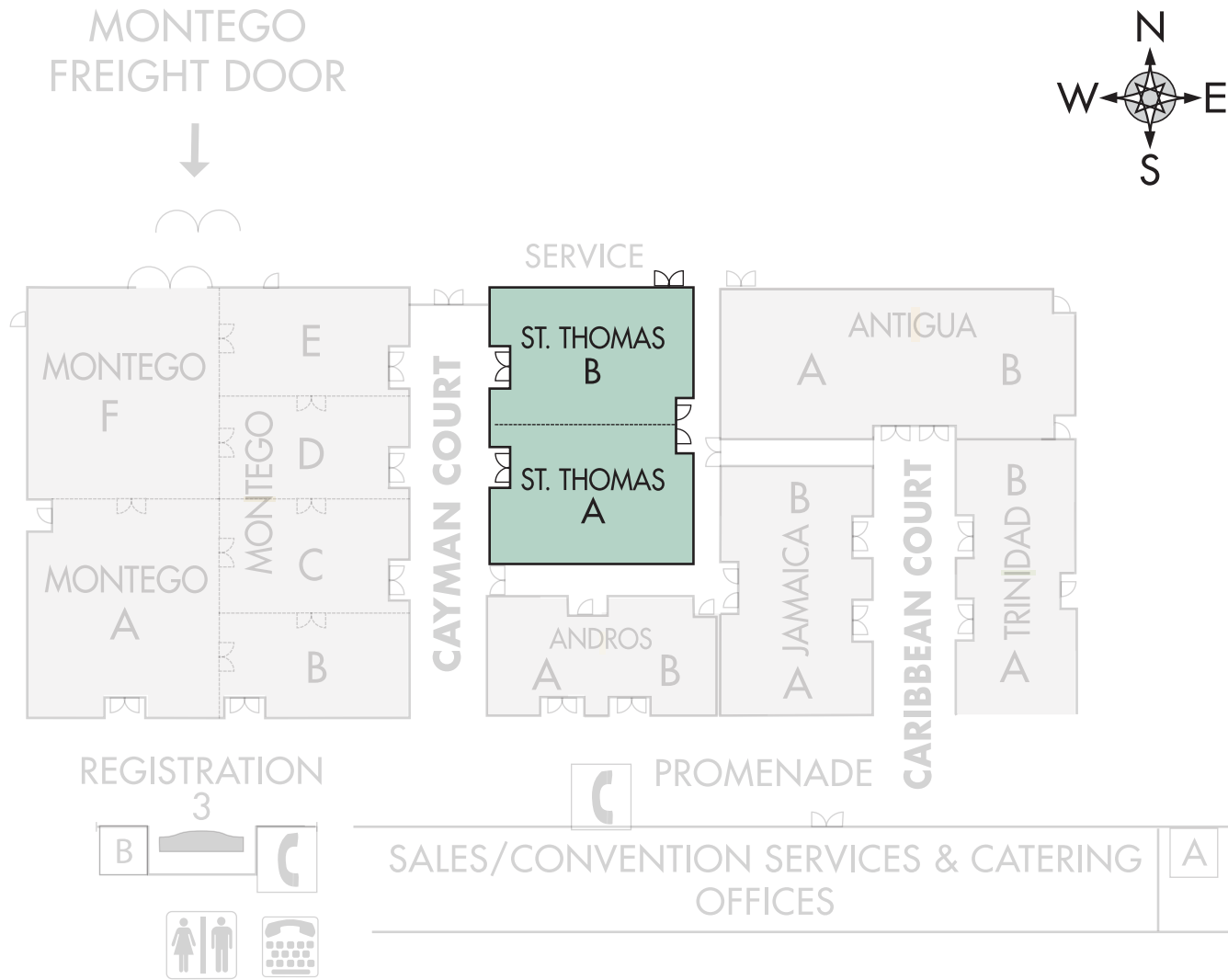

## St. Thomas

Dimensions	St. Thomas A & B	A	B
Square Feet	3,640	1,820	1,820
Dimensions L x W	70' x 52'	35' x 52'	35' x 52'
Ceiling Height	16'	16'	16'
Capacities	St. Thomas A & B	A	B
Theatre	330	170	170
School Room	205	125	115
Hollow Square	90	50	50
U-Shape	70	45	45
Cone	60	40	40
Cocktail reception	275	115	120
Banquet	190	100	90
8'x10' Exhibits	N/A	N/A	N/A
10'x10' Exhibits	N/A	N/A	N/A

# Mirage Trinidad Room Dimensions

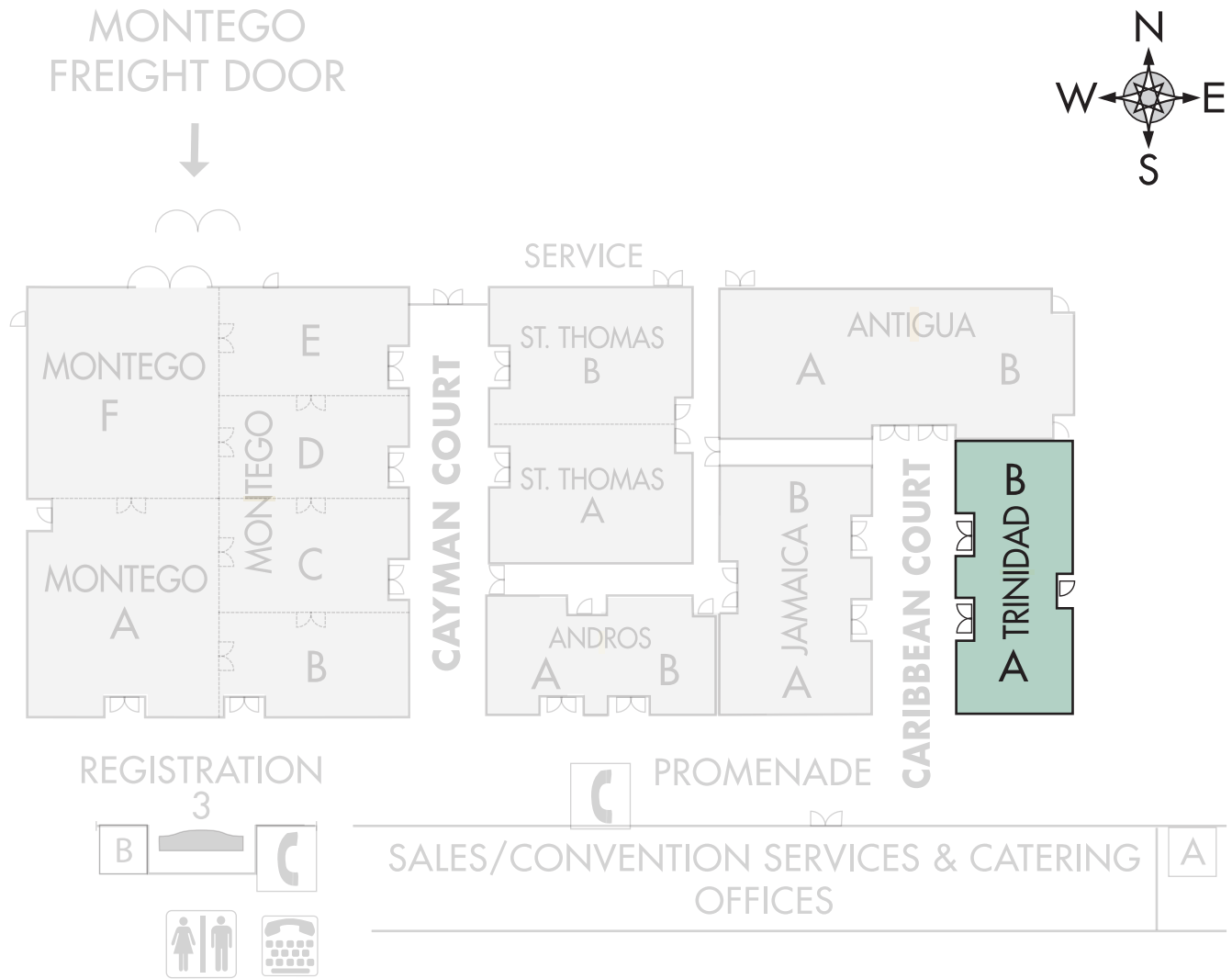

## Trinidad

Dimensions	Trinidad A & B	A	B
Square Feet	2,170	1,085	1,634
Dimensions L x W	70' x 31'	35' x 31'	35' x 31'
Ceiling Height	14'	14'	14'
Capacities	Trinidad A & B	A	B
Theatre	145	80	80
School Room	110	50	50
Hollow Square	70	35	35
U-Shape	60	30	30
Cone	60	25	25
Cocktail reception	165	65	65
Banquet	100	50	50
8'x10' Exhibits	N/A	N/A	N/A
10'x10' Exhibits	N/A	N/A	N/A

# Mirage Barbados Room Dimensions

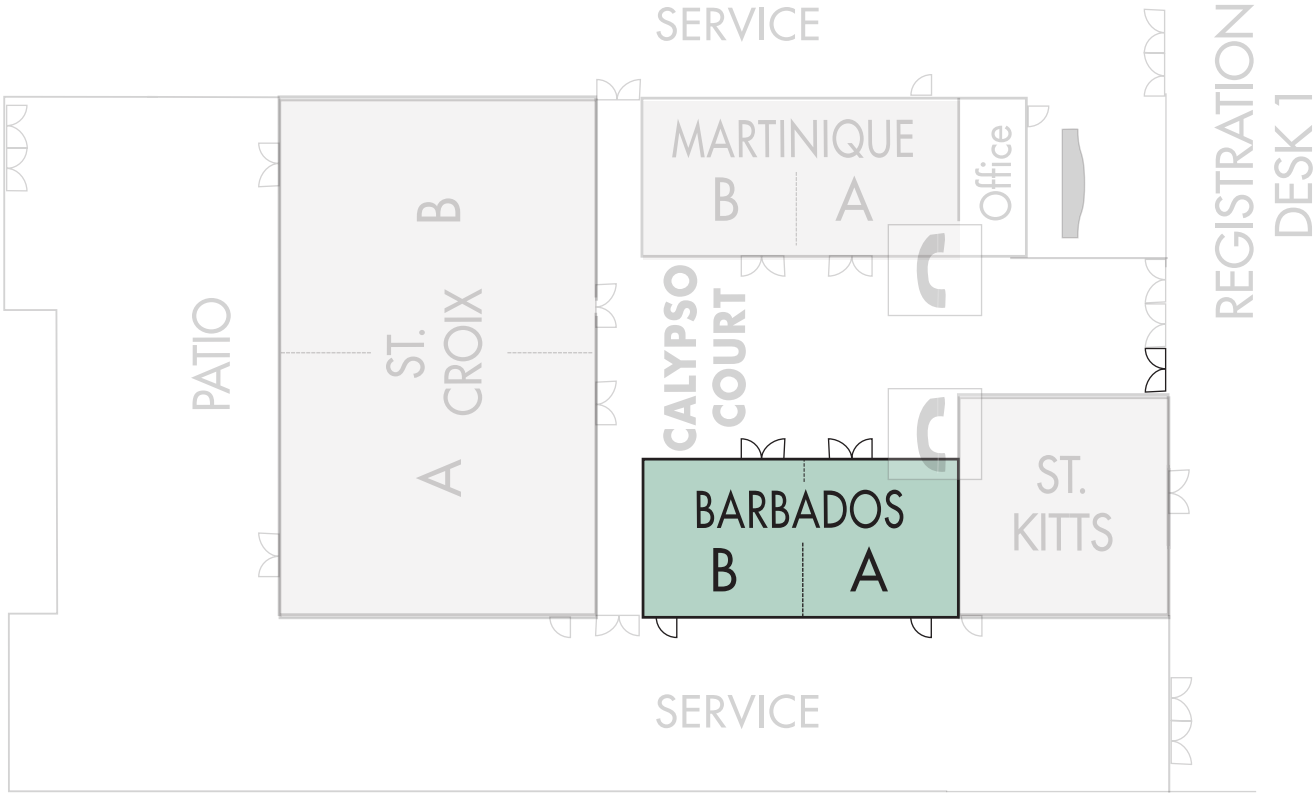
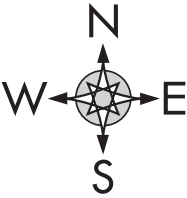

## Barbados

Dimensions	Barbados A & B	A	B
Square Feet	1,800	900	900
Dimensions L x W	60' x 30'	30' x 30'	30' x 30'
Ceiling Height	12'	12'	12'
Capacities	Barbados A & B	A	B
Theatre	145	70	70
School Room	100	45	45
Hollow Square	70	30	30
U-Shape	60	25	25
Cone	50	25	25
Cocktail reception	120	60	60
Banquet	90	40	40
8'x10' Exhibits	N/A	N/A	N/A
10'x10' Exhibits	N/A	N/A	N/A

# Mirage Bermuda Room Dimensions

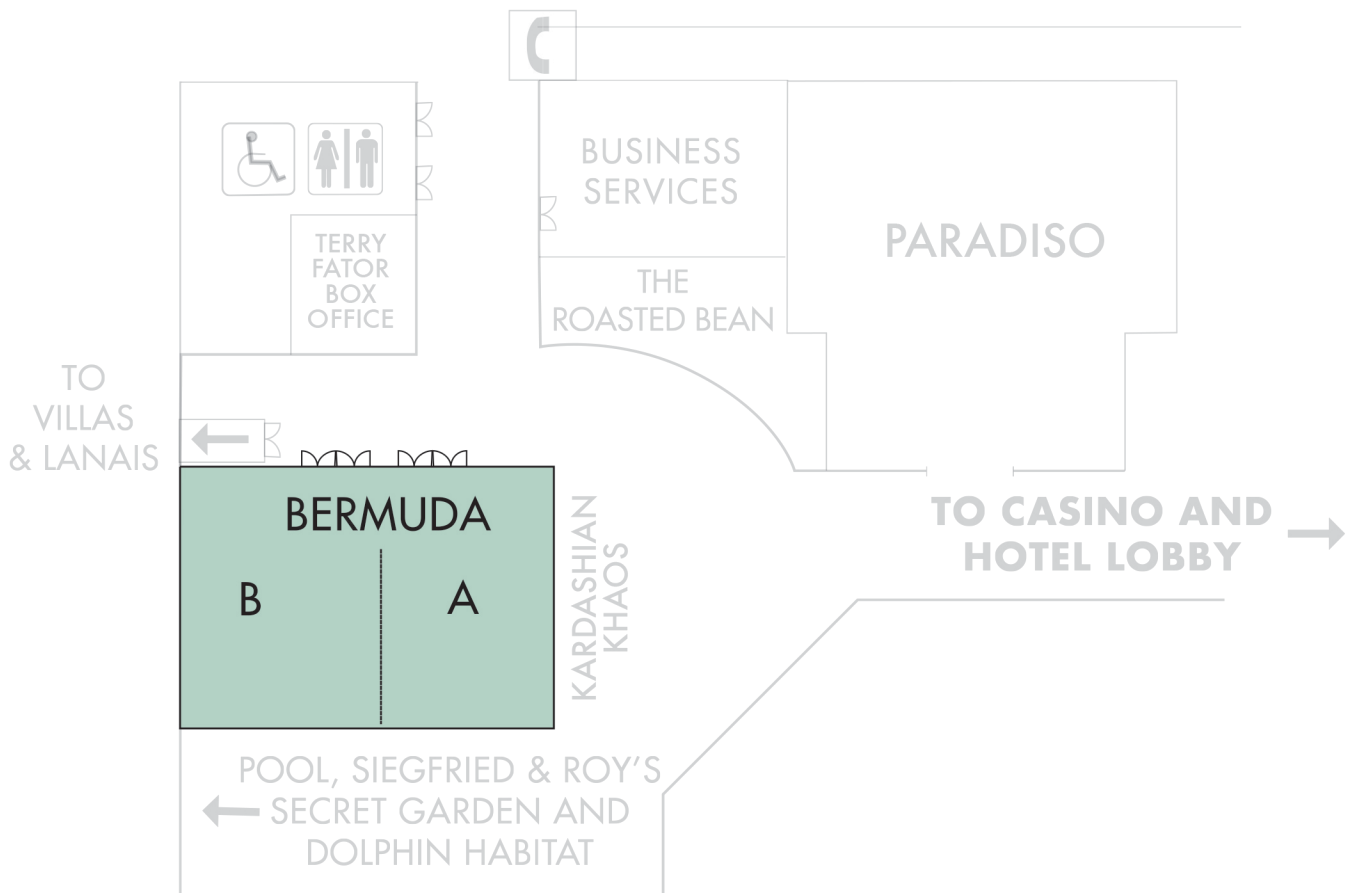
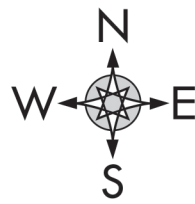

## Bermuda

Dimensions	Bermuda A & B	A	B
Square Feet	5,280	2,640	2,640
Dimensions L x W	88' x 60'	44' x 60'	44' x 60'
Ceiling Height	16'	16'	16'
Capacities	Bermuda A & B	A	B
Theatre	420	230	230
School Room	285	130	130
Hollow Square	110	55	55
U-Shape	90	45	45
Cone	70	35	35
Cocktail reception	360	180	180
Banquet	300	150	150
8'x10' Exhibits	N/A	N/A	N/A
10'x10' Exhibits	N/A	N/A	N/A

# Mirage Martinique Room Dimensions

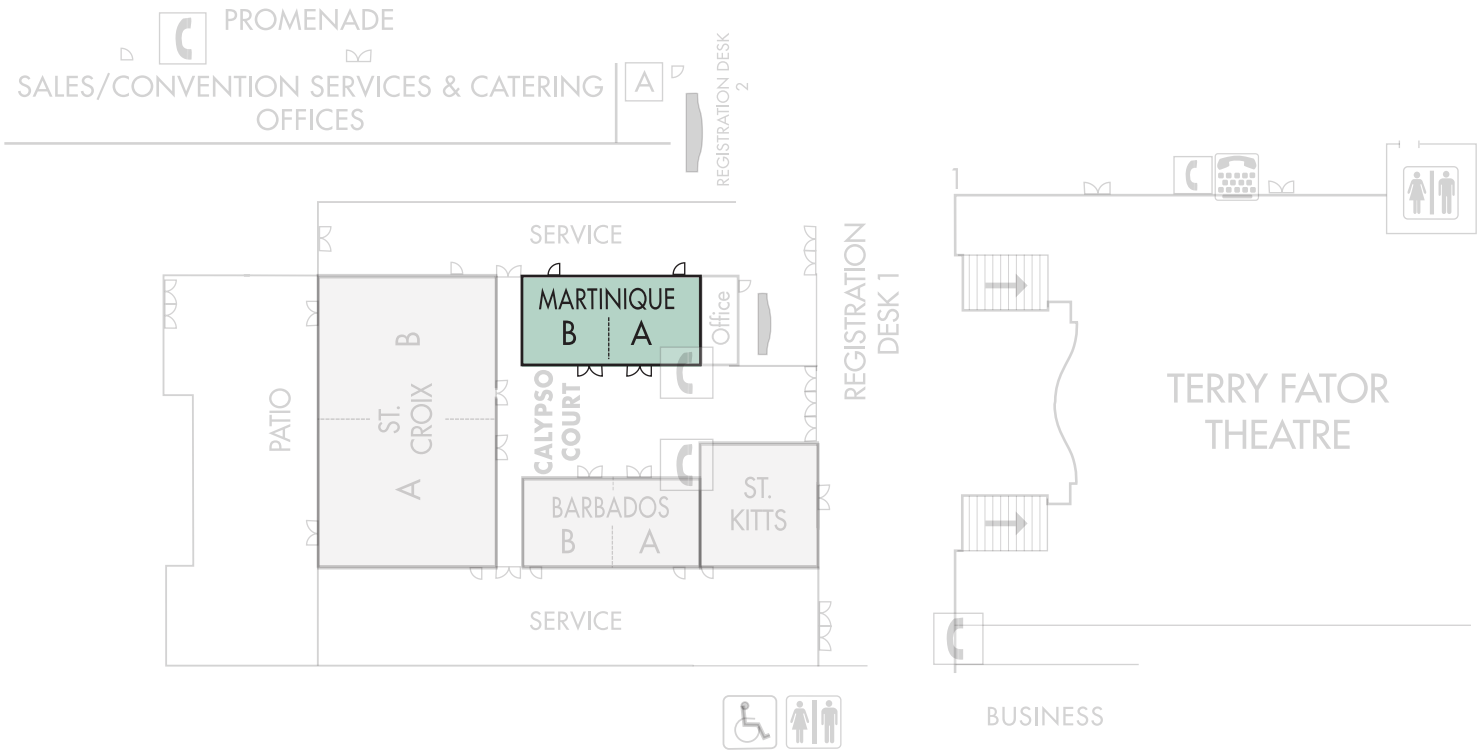
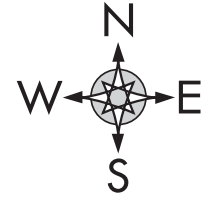

## Martinique

Dimensions	Martinique A & B	A	B
Square Feet	1,800	900	900
Dimensions L x W	60' x 30'	30' x 30'	30' x 30'
Ceiling Height	12'	12'	12'
Capacities	Martinique A & B	A	B
Theatre	145	45	45
School Room	100	45	45
Hollow Square	70	30	30
U-Shape	60	25	25
Cone	50	25	25
Cocktail reception	120	60	60
Banquet	90	40	40
8'x10' Exhibits	N/A	N/A	N/A
10'x10' Exhibits	N/A	N/A	N/A

# Mirage St. Croix Room Dimensions

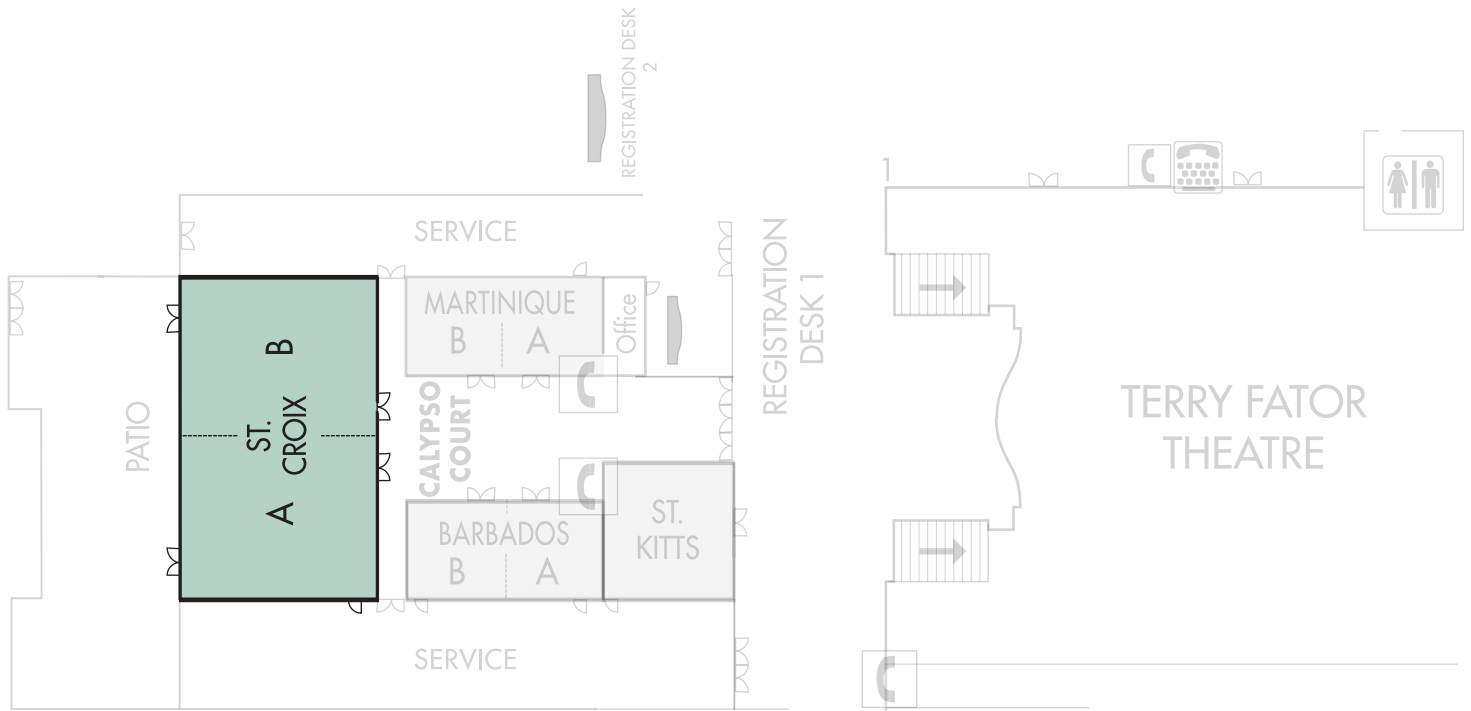
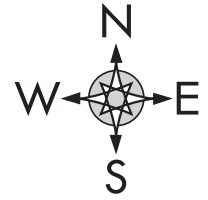

## St. Croix

Dimensions	St.Croix A & B	A	B
Square Feet	4,680	2,340	2,340
Dimensions L x W	90' x 52'	45' x 52'	45' x 52'
Ceiling Height	17'	17'	17'
Capacities	St.Croix A & B	A	B
Theatre	380	200	200
School Room	240	120	120
Hollow Square	90	45	45
U-Shape	80	40	40
Cone	60	30	30
Cocktail reception	310	150	150
Banquet	260	130	130
8'x10' Exhibits	N/A	N/A	N/A
10'x10' Exhibits	N/A	N/A	N/A

# Mirage St. Kitts Room Dimensions

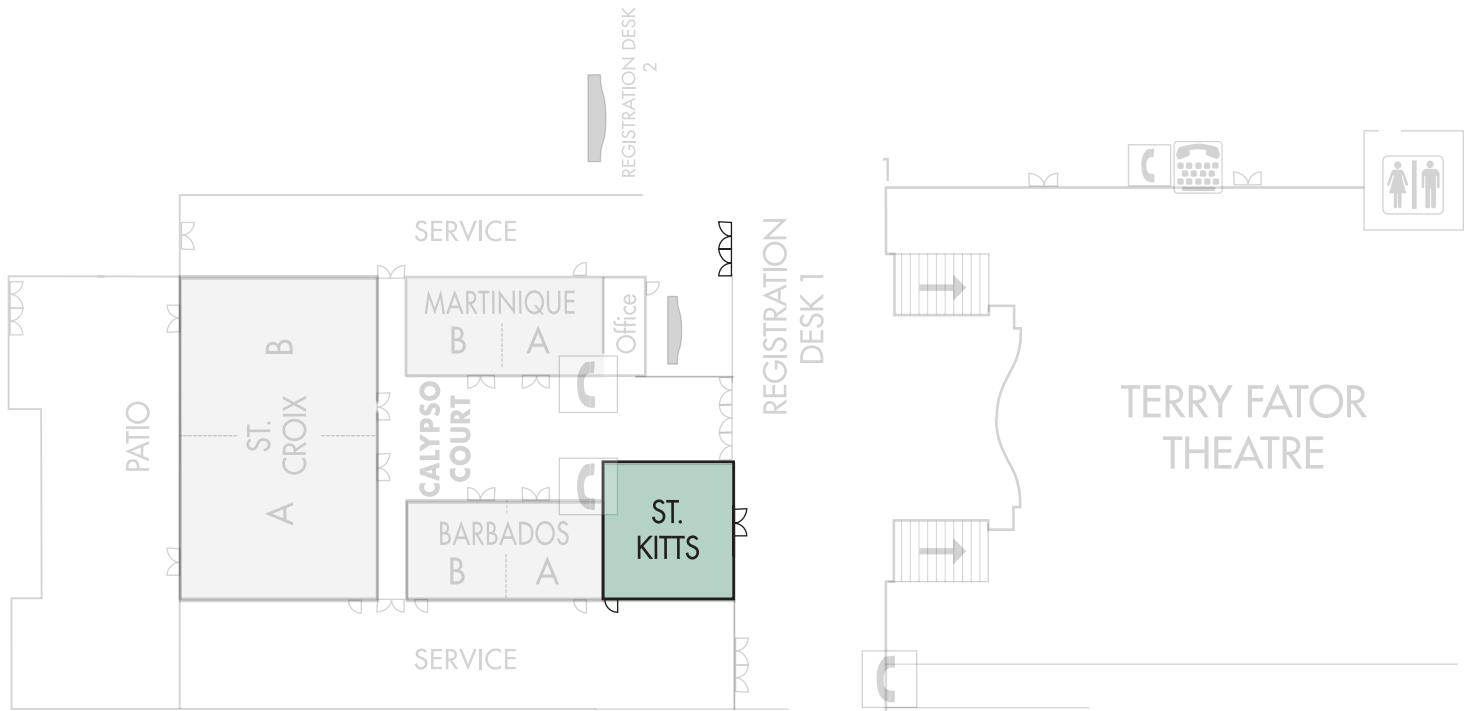
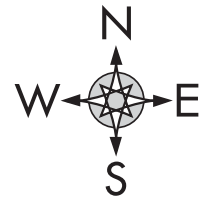

## St. Kitts

### Dimensions

Dimensions	St. Kitts
Square Feet	1,148
Dimensions L x W	41' x 28'
Ceiling Height	12'

### Capacities

Capacities	St. Kitts
Theatre	115
School Room	55
Hollow Square	40
U-Shape	35
Cone	30
Cocktail reception	80
Banquet	60
8'x10' Exhibits	N/A
10'x10' Exhibits	N/A

# Mirage Antigua Room Dimensions

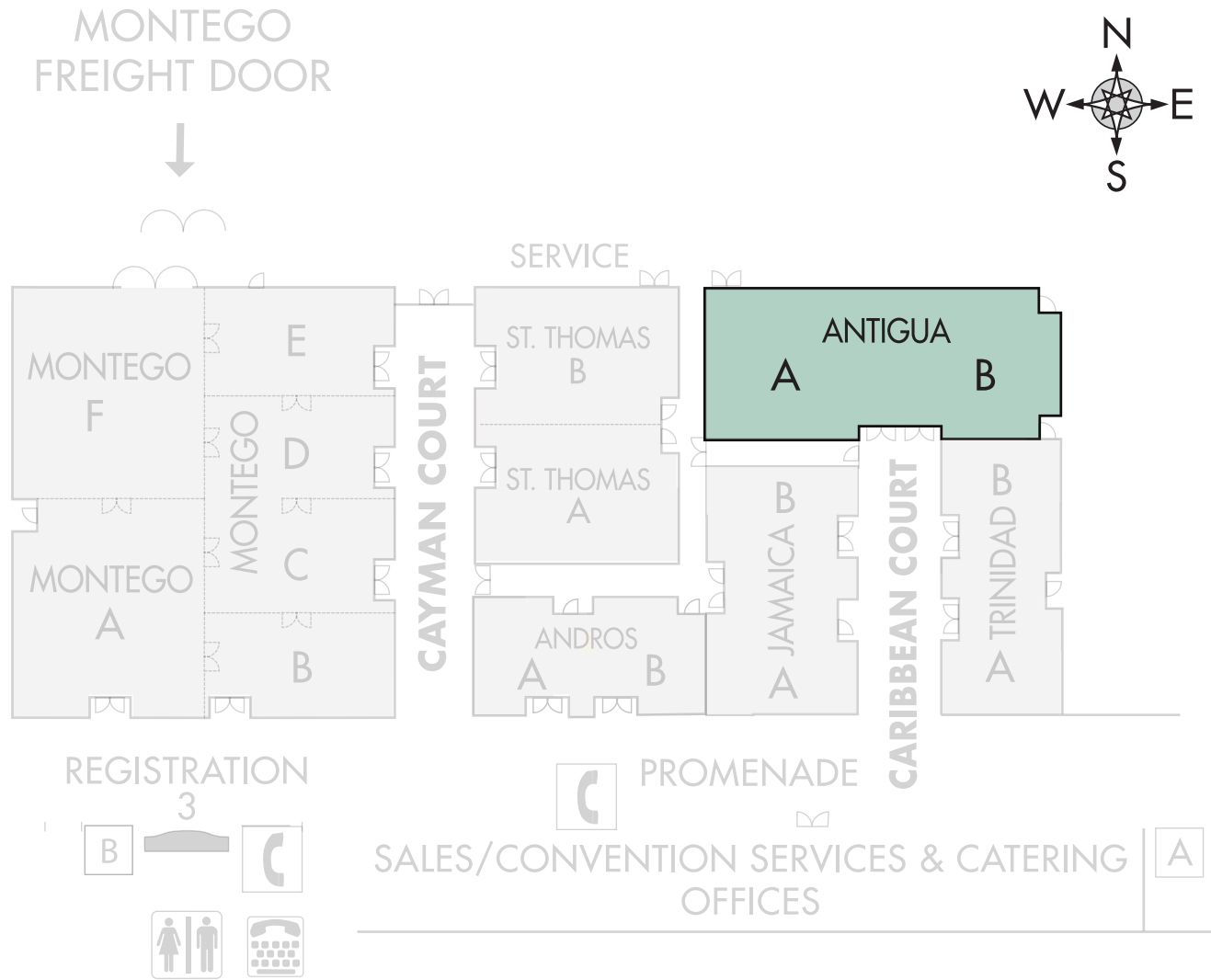

## Antigua

Dimensions	Antigua A & B	A	B
Square Feet	3,420	1,786	1,634
Dimensions L x W	91' x 38'	28' x 31'	31' x 31'
Ceiling Height	16'	16'	16'
Capacities	Antigua A & B	A	B
Theatre	300	150	130
School Room	175	115	100
Hollow Square	95	50	45
U-Shape	85	45	40
Cone	80	40	35
Cocktail reception	230	140	100
Banquet	200	100	100
8'x10' Exhibits	N/A	N/A	N/A
10'x10' Exhibits	N/A	N/A	N/A